

---

**MANDATORY SERVICE BULLETIN NO. MSB 62-049 REV. 3**  
**SUPERSEDES MSB 62-049 REV. 2**

**I TECHNICAL DETAILS**

**I.1 Category**

Mandatory.

**I.2 Airplanes Affected**

Model: DA 62  
S/N: 62.191 and prior.  
62.C041 and prior.

**I.3 Date of Effectivity**

21 November 2024.

**I.4 Time of Compliance**

At the next removal of the drain covers P/N D67-5741-17-00.

**I.5 Subject**

Installation of hinged drain cover.  
ATA code: 52-40.

**I.6 Reason**

It has come to Diamond's attention that some DA 62 aircraft had vent hoses kinked during installation of the previously approved drain cover P/N D67-5741-17-00, resulting in restricted airflow and potential damage to the fuel tanks. For this reason, Diamond has introduced a hinged drain cover, which offers improved visibility during cover re-installation, allowing maintenance personnel to verify the vent hoses are aligned and not kinked. This service bulletin describes the replacement of the existing drain cover with the new hinged drain cover.

**I.7 Concurrent Documents**

None.

**I.8 Approval**

The technical information and instructions contained in this document relate to Design Change Advisory MÄM 62-1074, which has been approved as part of the type design.

**I.9 Accomplishment/Instructions**

See WI-MSB 62-049, latest effective issue.

**I.10 Mass (Weight) and CG**

The change in mass and CG is negligible.

**II PLANNING INFORMATION**

**II.1 Material and Availability**

See WI-MSB 62-049, latest effective issue.

**II.2 Special Tools**

None.

**II.3 Labour Effort**

Approximately 0.5 hours will be required to accomplish this service bulletin.

*This estimate is for direct labour performed by a technician, and it does not include setup, planning, familiarization, cure time, part fabrication, or tool acquisition.*

**II.4 Credit**

Parts and labour for all aircraft within warranty.

**II.5 Reference Documents**

DA 62 Series Airplane Maintenance Manual, Doc. No. 7.02.25, latest effective issue.

**III REMARKS**

1. All work must be done by the appropriate authorized personnel.
2. All work, in particular which is not especially described in this service bulletin, must be done in accordance with the referenced maintenance manual.
3. Completion of all work must be recorded in the logbook.
4. In case of doubt, contact Diamond Aircraft Industries Inc.



---

**EXECUTION REPORT TO  
SERVICE BULLETIN  
MSB 62-049 REV. 3**

**AIRPLANE DATA**

Airplane serial number \_\_\_\_\_

Airplane registration \_\_\_\_\_

Airplane operator \_\_\_\_\_

Hours of operation of airplane (TSN) \_\_\_\_\_

Typical operation of airplane private, club, training, other: \_\_\_\_\_

**MAINTENANCE DATA**

Date of maintenance \_\_\_\_\_

Maintenance carried out by \_\_\_\_\_

During scheduled inspection?  Yes  No \_\_\_\_\_

---

Name Signature Date

Please submit the Execution Report through the Diamond Partner Portal at  
<https://partners.diamondaircraft.com/>

**WORK INSTRUCTION WI-MSB 62-049 REV. 3**  
**SUPERSEDES WI-MSB 62-049 REV. 2**

**I GENERAL INFORMATION**

**I.1 Subject**

Installation of hinged drain cover.

ATA code: 52-40

**I.2 Reference Documents**

DA 62 Series Airplane Maintenance Manual, Doc. No. 7.02.25, latest effective issue.

**I.3 Remarks**

1. All work must be done by a certified aircraft service station or a certified aircraft maintenance mechanic.
2. All work, in particular which is not especially described in this work instruction, must be done in accordance with the referenced maintenance manual.
3. In case of doubt, contact Diamond Aircraft Industries Inc.

**II DRAWINGS, SPECIAL TOOLS & MATERIALS**

**II.1 Drawings**

None.

**II.2 Special Tools**

None.

**II.3 Material**

Item	Quantity	Part Number	Description
1	2	D53-5741-17-00	Drain cover*
2	6	ISO7380-M5x12-A2	Screw, hex. socket button head
3	6	DIN 125A5,3-PA	Washer

\* Provide the paint color code of the aircraft with the drain cover order to receive the drain covers with the correct color.

### **III INSTRUCTIONS**

1. Remove the existing drain cover P/N D67-5741-17-00. Refer to AMM Section 52-40.
2. Install the hinged drain cover (refer to Figure 1):
  - a. Ensure the two vent hoses are in satisfactory condition.
  - b. Ensure the two cover hoses are circular (i.e., not deformed).
  - c. Install the hinged drain cover:
    - i. Install the screw, two washers, and nut that connect the bonding wire to the hinged drain cover.
    - ii. Attach the larger part of the cover to the bottom of the wing using two screws (item 2) and two washers (item 3). Ensure the cover hoses and vent hoses engage without kinking.

**CAUTION:** DO NOT USE EXCESSIVE FORCE WHEN INSTALLING THE COVER.

- iii. Double check that the cover hoses and vent hoses are engaged and that there are no kinks, and attach the hinged part of the cover to the bottom of the wing using a screw (item 2) and washer (item 3).
3. Repeat steps 1 and 2 for the opposite wing.

NOTE: Reuse the bonding wires and their attaching hardware only if they are in a serviceable condition.
4. Clean the working areas, and check for foreign objects.
5. Check all altered, replaced, and repaired parts for proper function.
6. Make all necessary entries in the airplane logs.
7. Fill in the execution report, and submit it through the Diamond Partner Portal at <https://partners.diamondaircraft.com/>.

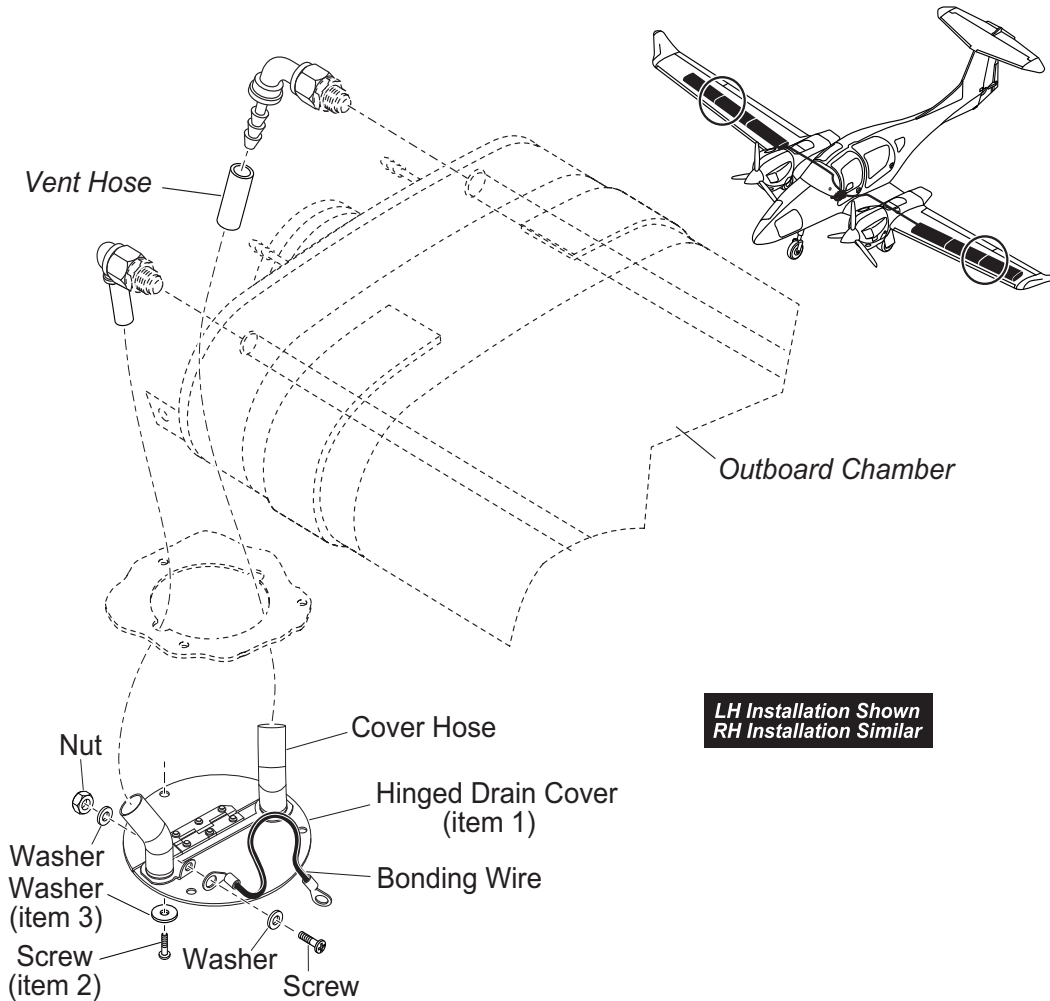

Figure 1. Hinged drain cover installation.

To obtain satisfactory results, procedures specified in this service bulletin must be accomplished in accordance with accepted methods and current government regulations. Diamond Aircraft cannot be responsible for the quality of work performed in accomplishing the requirements of this service bulletin. Diamond Aircraft reserves the right to void continued warranty coverage in the area affected by this service bulletin if it is not incorporated.

If you no longer own the aircraft to which this service bulletin applies, please forward it to the current owner, and send the name of the current owner to Diamond Aircraft at the address below.

Diamond Aircraft Industries Inc.  
1560 Crumlin Sideroad, London, Ontario, Canada  
N5V 1S2

Customer Support:  
Phone: (519) 457-4041, Fax: (519) 457-4045  
Portal: [partners.diamondaircraft.com](https://partners.diamondaircraft.com)