

# TEMPORARY REVISION

## AMM-TR-MÄM 42-1219/a

### supersedes AMM-TR-MÄM 42-1219

## New Fuel Pump

This Temporary Revision AMM-TR-OÄM 42-1219/a is approved in conjunction with the Mandatory Design Change Advisory MÄM 42-1219/c and is valid in conjunction with the Airplane Maintenance Manual (AMM) until this Temporary Revision has been incorporated into the AMM.

The limitations and information contained herein either supplement or, in the case of conflict, override those in the AMM.

The technical information contained in this document has been approved under the authority of DOA No. EASA.21J.052.

Doc. No.	Section	Affected Pages
7.02.15	20-00-00	1a, 1aa
	20-80-00	1, 2
	28-20-00	222a, 222b, 222c, 222d, 222e, 222ee
	28-21-00	219a, 219b, 219c, 219cc

#### Instruction

- Print this document double-sided on yellow paper (odd pages and "a" pages on front sides, even pages and "aa" pages on reverse sides).
- Insert this cover page as the first page of the AMM.
- Insert the other pages of this Temporary Revision in front of the corresponding AMM pages.

Intentionally left blank

**AFFECTED CHAPTERS:**

**CHAPTER 20**  
**STANDARD PRACTICES**

**1. General**

*The following Section is added to the AMM:*

- Section 20-80. Standard Practices - Low Pressure Fuel Pumps Assembly.

Intentionally left blank

---

**Section 20-80**  
**Standard Practices - Low Pressure Fuel Pump Assembly**

**1. General**

This Section gives you data about the special torque values for the DA 42 NG airplane.

Note: Use the standard torque values where no specific values are given.

**2. Special Torque Values**

Connection/Parts	Torque (Nm)	Torque (lbf.ft)
Hollow bolts torques.	D-08: 18 ± 2	D-08: 13.3 ± 1.5
	D-06: 18 ± 2	D-06: 13.3 ± 1.5
Prefilter torque.	18 ± 2	13.3 ± 1.5
Negative clamp torque.	1.6 - 2.0	1.2 - 1.5
Positive clamp torque.	1.2 - 1.6	0.9 - 1.2

*If MÄM 42-480 is installed:*

Connection/Parts	Torque (Nm)	Torque (lbf.ft)
Hollow bolts torques.	18 ± 2	13.3 ± 1.5
Plug nuts torque.	18 ± 2	13.3 ± 1.5
Prefilter torque.	18 ± 2	13.3 ± 1.5
Check valve torque.	18 ± 2	13.3 ± 1.5
Negative clamp torque.	1.6 - 2.0	1.2 - 1.5
Positive clamp torque.	1.2 - 1.6	0.9 - 1.2

*If MÄM 42-1219 is installed:*

Connection/Parts	Torque (Nm)	Torque (lbf.ft)
Pump fitting torque.	17 - 25	12.5 - 18.4
Hollow bolts torque.	18 ± 2	13.3 ± 1.5
Plug nuts torque.	18 ± 2	13.3 ± 1.5
Prefilter torque.	18 ± 2	13.3 ± 1.5
Check valve torque.	18 ± 2	13.3 ± 1.5
Negative clamp torque.	1.6 - 2.0	1.2 - 1.5
Positive clamp torque.	1.2 - 1.6	0.9 - 1.2
Hose clamp torque.	3 - 3.5	2.2 - 2.6

**CHAPTER 28**  
**FUEL**  
**Section 28-20**  
**Fuel Distribution**

**MAINTENANCE PRACTICES**

**7. Remove/Install the Low Pressure Fuel Pumps**

*The procedure is amended to read:*

**B. Install Low Pressure Fuel Pumps**

	<b>Detail Steps/Work Items</b>	<b>Key Items/References</b>
(1)	Install the low pressure fuel pump assembly: <ul style="list-style-type: none"> <li>– Install the aluminum washers, the two prefilters, the solid bridges, and the hollow bolts.</li> <li>– Install the fuel pumps assembly to the bracket.</li> <li>– Connect the electric wires to the fuel pumps.</li> <li>– Connect the fuel hoses to the solid bridges.</li> <li>– Secure hollow bolts with safety wire.</li> </ul>	Refer to Figure 6.  Hollow bolts torque: D-08: 18 ± 2 Nm (13.3 ± 1.5 lbf.ft.) D-06: 18 ± 2 Nm (13.3 ± 1.5 lbf.ft.)  Prefilter torque: 18 ± 2 Nm (13.3 ± 1.5 lbf.ft.)  Negative clamp torque: 1.6 - 2.0 Nm (1.2 - 1.5 lbf.ft.)  Positive clamp torque: 1.2 - 1.6 Nm (0.9 - 1.2 lbf.ft.)

	Detail Steps/Work Items	Key Items/References
(2)	<p>Install the low pressure fuel pump assembly (if MÄM 42-480 is installed):</p> <ul style="list-style-type: none"> <li>- Install the aluminum washers, the two prefilters, the solid bridge, and the two hollow bolts.</li> <li>- Install the washers, the two check valves, the solid bridge, and the two plug nuts.</li> <li>- Secure plug nuts with safety wire.</li> <li>- Install the fuel pumps assembly to the bracket.</li> <li>- Connect the electric wires to the fuel pumps.</li> <li>- Connect the fuel hoses to the solid bridges.</li> <li>- Secure hollow bolts with safety wire.</li> </ul>	<p>Refer to Figure 7.</p> <p>Hollow bolts torque: 18 ± 2 Nm (13.3 ± 1.5 lbf.ft.)</p> <p>Plug nuts torque: 18 ± 2 Nm (13.3 ± 1.5 lbf.ft.)</p> <p>Prefilter torque: 18 ± 2 Nm (13.3 ± 1.5 lbf.ft.)</p> <p>Check valve torque: 18 ± 2 Nm (13.3 ± 1.5 lbf.ft.)</p> <p>Negative clamp torque: 1.6 - 2.0 Nm (1.2 - 1.5 lbf.ft.)</p> <p>Positive clamp torque: 1.2 - 1.6 Nm (0.9 - 1.2 lbf.ft.)</p>



	Detail Steps/Work Items	Key Items/References
(3)	<p>Install the low pressure fuel pump assembly (if MÄM 42-1219 is installed):</p> <ul style="list-style-type: none"> <li>- Install the fittings and copper washers provided with the fuel pumps.</li> <li>- Install the aluminum washers (new), the two pre-filters, the solid bridge, and the two hollow bolts.</li> <li>- Install the washers, the two check valves, the solid bridge, and the two plug nuts.</li> <li>- Secure plug nuts and hollow bolts with safety wire.</li> <li>- Install the T-fitting, the bypass valve and the bypass fuel line.</li> <li>- Install the fuel pumps assembly to the bracket.</li> <li>- Connect the electric wires to the fuel pumps.</li> <li>- Connect the fuel hoses to the bypass valve and the T-fitting.</li> </ul>	<p>Refer to Figure 7A.</p> <p>Pump fitting torque: 17 - 25 Nm (12.5 - 18.4 lbf.ft.)</p> <p>Hollow bolts torque: 18 ± 2 Nm (13.3 ± 1.5 lbf.ft.)</p> <p>Plug nuts torque: 18 ± 2 Nm (13.3 ± 1.5 lbf.ft.)</p> <p>Prefilter torque: 18 ± 2 Nm (13.3 ± 1.5 lbf.ft.)</p> <p>Check valve torque: 18 ± 2 Nm (13.3 ± 1.5 lbf.ft.)</p> <p>Hose clamp torque: 3 - 3.5 Nm (2.2 - 2.6 lbf.ft.)</p> <p>Negative clamp torque: 1.6 - 2.0 Nm (1.2 - 1.5 lbf.ft.)</p> <p>Positive clamp torque: 1.2 - 1.6 Nm (0.9 - 1.2 lbf.ft.)</p>

	Detail Steps/Work Items	Key Items/References
(4)	Do a test for leaks of the filter assembly: <ul style="list-style-type: none"><li>- Make sure that there is fuel in the related fuel tank.</li><li>- Reset the circuit breaker of the fuel pumps.</li><li>- Set the FUEL SELECTOR lever to the related tank.</li><li>- Examine the filter assembly for leaks while both low pressure fuel pumps are running.</li></ul>	

The following figure is added:

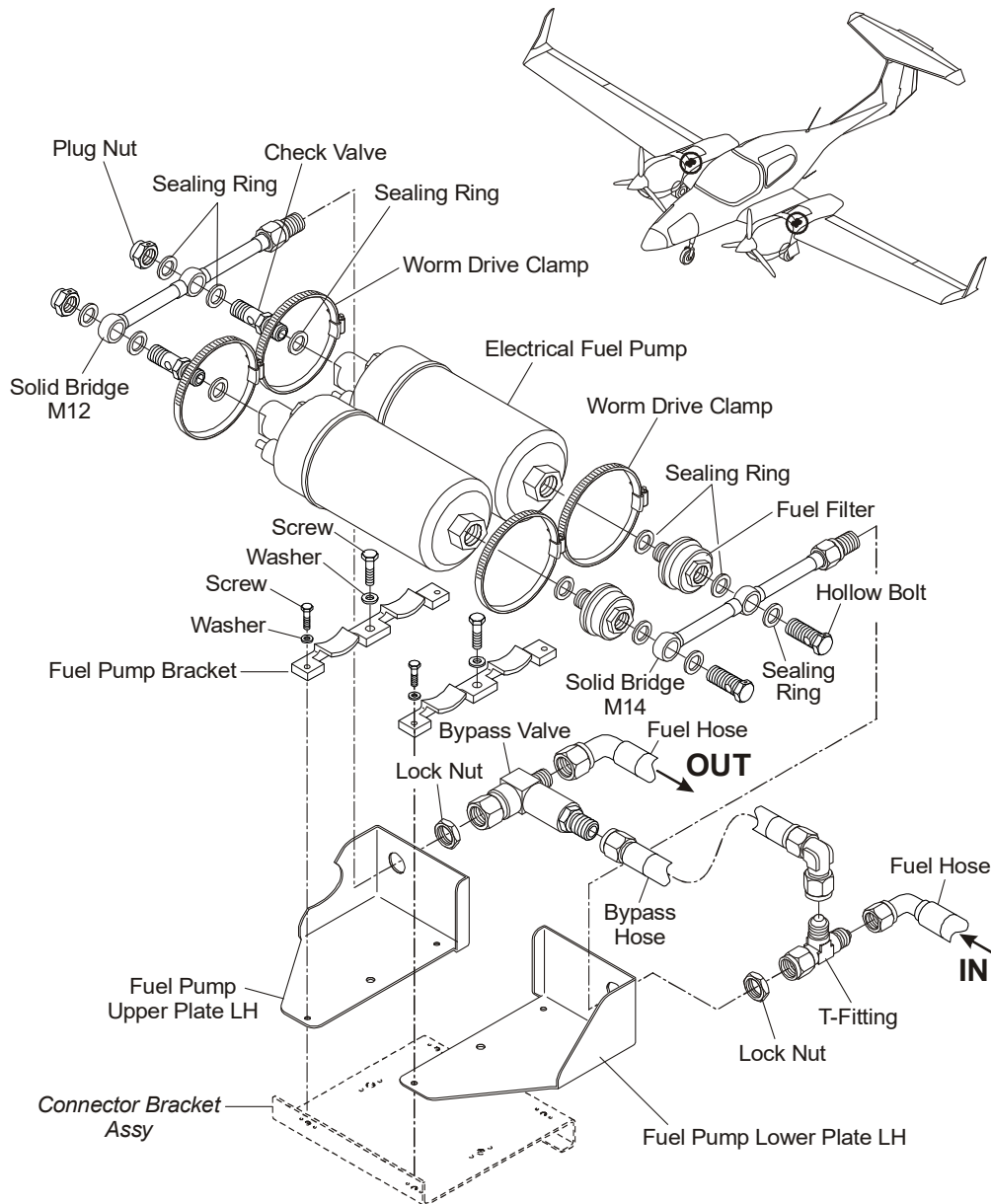

Figure 7A: Fuel Pumps Assembly (if MÄM 42-1219 is installed)

Intentionally left blank

**Section 28-21**  
**Fuel Distribution (if MÄM 42-600 is installed)**

**MAINTENANCE PRACTICES**

**7. Remove/Install the Low Pressure Fuel Pumps**

*The procedure is amended to read:*

**B. Install Low Pressure Fuel Pumps**

	<b>Detail Steps/Work Items</b>	<b>Key Items/References</b>
(1)	Install the low pressure fuel pump assembly: <ul style="list-style-type: none"> <li>- Install the aluminum washers (new), the two pre-filters, the solid bridge, and the two hollow bolts.</li> <li>- Install the washers, the two check valves, the solid bridge, and the two plug nuts.</li> <li>- Secure plug nuts and hollow bolts with safety wire.</li> <li>- Install the T-fitting, the bypass valve and the bypass fuel line.</li> <li>- Install the fuel pumps assembly to the bracket.</li> <li>- Connect the electric wires to the fuel pumps.</li> <li>- Connect the fuel hoses to the bypass valve and the T-fitting.</li> </ul>	Refer to Figure 8.  Hollow bolts torque: 18 ± 2 Nm (13.3 ± 1.5 lbf.ft.)  Plug nuts torque: 18 ± 2 Nm (13.3 ± 1.5 lbf.ft.)  Prefilter torque: 18 ± 2 Nm (13.3 ± 1.5 lbf.ft.)  Check valve torque: 18 ± 2 Nm (13.3 ± 1.5 lbf.ft.)   Negative clamp torque: 1.6 - 2.0 Nm (1.2 - 1.5 lbf.ft.)  Positive clamp torque: 1.2 - 1.6 Nm (0.9 - 1.2 lbf.ft.)

<p>(2)</p>	<p>Install the low pressure fuel pump assembly (if MÄM 42-1219 is installed):</p> <ul style="list-style-type: none"> <li>- Install the fittings and copper washers provided with the fuel pumps.</li> <li>- Install the aluminum washers (new), the two pre-filters, the solid bridge, and the two hollow bolts.</li> <li>- Install the washers, the two check valves, the solid bridge, and the two plug nuts.</li> <li>- Secure plug nuts and hollow bolts with safety wire.</li> <li>- Install the T-fitting, the bypass valve and the bypass fuel line.</li> <li>- Install the fuel pumps assembly to the bracket.</li> <li>- Connect the electric wires to the fuel pumps.</li> <li>- Connect the fuel hoses to the bypass valve and the T-fitting.</li> </ul>	<p>Refer to Figure 8A.</p> <p>Pump fitting torque: 17 - 25 Nm (12.5 - 18.4 lbf.ft.)</p> <p>Hollow bolts torque: 18 ± 2 Nm (13.3 ± 1.5 lbf.ft.)</p> <p>Plug nuts torque: 18 ± 2 Nm (13.3 ± 1.5 lbf.ft.)</p> <p>Prefilter torque: 18 ± 2 Nm (13.3 ± 1.5 lbf.ft.)</p> <p>Check valve torque: 18 ± 2 Nm (13.3 ± 1.5 lbf.ft.)</p> <p>Hose clamp torque: 3 - 3.5 Nm (2.2 - 2.6 lbf.ft.)</p> <p>Negative clamp torque: 1.6 - 2.0 Nm (1.2 - 1.5 lbf.ft.)</p> <p>Positive clamp torque: 1.2 - 1.6 Nm (0.9 - 1.2 lbf.ft.)</p>
<p>(3)</p>	<p>Do a test for leaks of the filter assembly:</p> <ul style="list-style-type: none"> <li>- Make sure that there is fuel in the related fuel tank.</li> <li>- Reset the circuit breaker of the fuel pumps.</li> <li>- Set the FUEL SELECTOR lever to the related tank.</li> <li>- Examine the filter assembly for leaks while both low pressure fuel pumps are running.</li> </ul>	

The following figure is added:

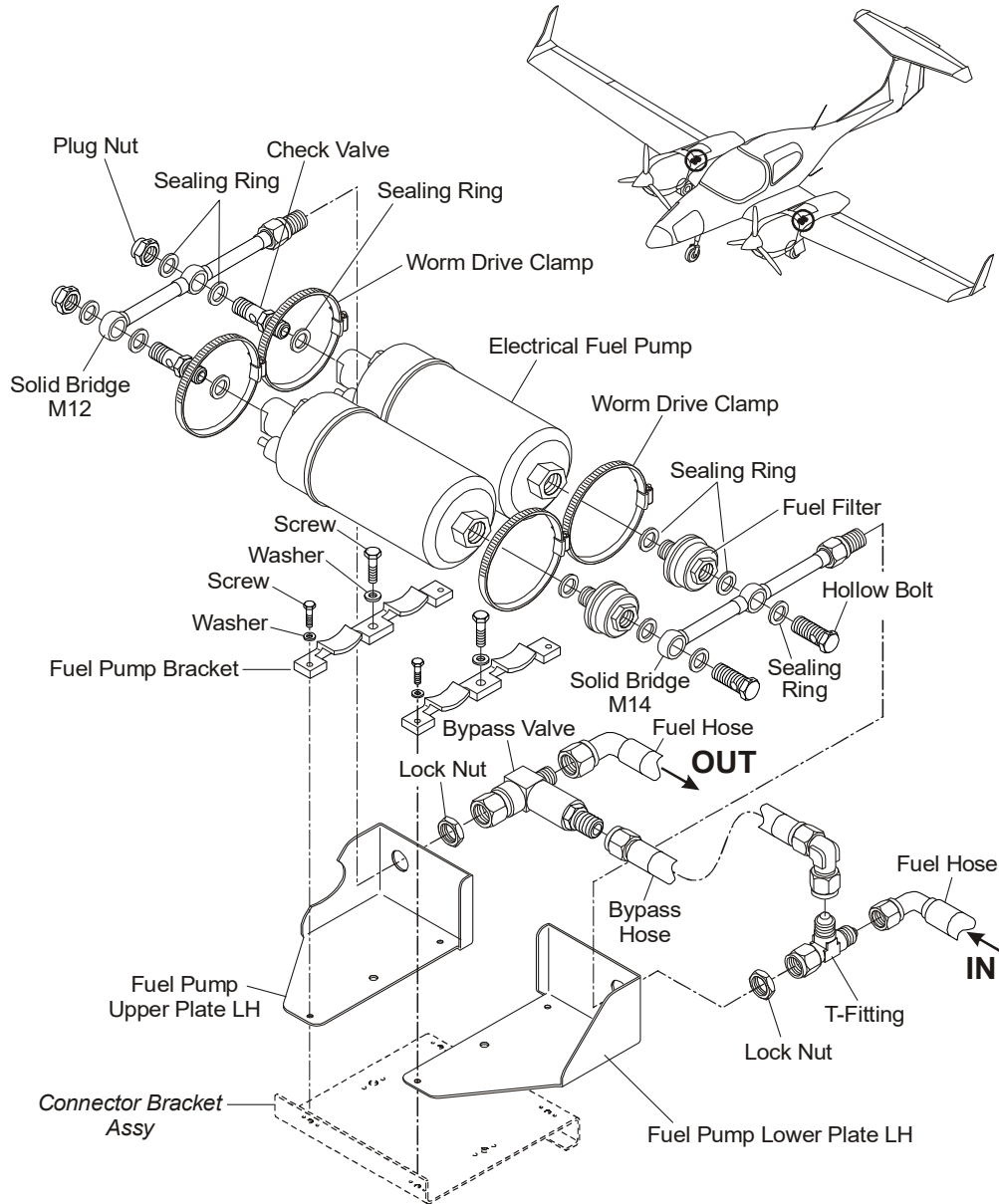

Figure 8A: Fuel Pumps Assembly (if MÄM 42-1219 is installed)

Intentionally left blank